

INSTRUCTION MANUAL

Blower

UB1102

UB1103

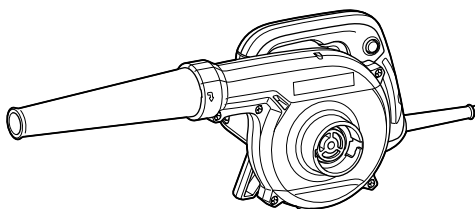

014255



DOUBLE INSULATION

IMPORTANT: Read Before Using.

ENGLISH (Original instructions)

SPECIFICATIONS

Model		UB1102	UB1103
Capacities	Air pressure	5.7 kPa	0 - 5.7 kPa
	Max. air volume	4.1 m ³ /min	0 - 4.1 m ³ /min
No load speed		16,000 min ⁻¹	0 - 16,000 min ⁻¹
Overall length		479 mm	479 mm
Net weight		2.0 kg	2.0 kg
Safety class		II/II	II/II







- Due to our continuing program of research and development, the specifications herein are subject to change without notice.
- Specifications may differ from country to country.
- Weight according to EPTA-Procedure 01/2003

END022-1

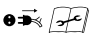
GEB113-2

Symbols

The following show the symbols used for the equipment. Be sure that you understand their meaning before use.

-  **WARNING:**
 -  • Switch off and remove plug from mains before cleaning or maintenance.
 -  • Read the operator's manual.
 -  • Keep a hand away from rotating parts.
 -  • Keep bystanders away.
 -  • Wear eye protection.
 -  • Do not use in the rain or leave outdoors while it is raining.
 -  • Only for EU countries
- Do not dispose of electric equipment together with household waste material! In observance of the European Directive, on Waste Electric and Electronic Equipment and its implementation in accordance with national law, electric equipment that have reached the end of their life must be collected separately and returned to an environmentally compatible recycling facility.

ENE018-1

Intended use

The tool is intended for blowing dust.

ENF002-2

Power supply

The tool should be connected only to a power supply of the same voltage as indicated on the nameplate, and can only be operated on single-phase AC supply. They are double-insulated and can, therefore, also be used from sockets without earth wire.

BLOWER SAFETY WARNINGS

 **WARNING: Read all safety warnings and all instructions.** Failure to follow the warnings and instructions may result in electric shock, fire and/or serious injury.

Training

- Read the instructions carefully. Be familiar with the controls and the proper use of the appliance.
- Never allow children to use the appliance.
- Never allow people unfamiliar with these instructions to use the appliance. Local regulations may restrict the age of the operator.
- Never operate the appliance while people, especially children, or pets are nearby.
- The operator or user is responsible for accidents or hazards occurring to other people or their property.
- This appliance is not intended for use by persons (including children) with reduced physical, sensory or mental capabilities, or lack of experience and knowledge, unless they have been given supervision or instruction concerning use of the appliance by a person responsible for their safety.

Preparation

1. While operating the appliance, always wear substantial footwear and long trousers.
2. Do not wear loose clothing or jewellery that can be drawn into the air inlet. Keep long hair away from the air inlets.
3. Wear protective goggles while operating.
4. To prevent dust irritation the wearing of a face mask is recommended.
5. Before using, check the supply and extension cord for signs of damage and aging. Do not use the appliance if the cord is damaged or worn.
6. Never operate the appliance with defective guards or shields, or without safety devices, for example debris collector in place.

7. Only use a weather proof extension cable fitted with a coupler according to IEC 60320-2-3.
8. It is recommended that the appliance should be supplied via a residual current device (RCD) with a tripping current of not more than 30 mA;

Operation

9. Always direct the cable to the rear away from the appliance.
10. If a cord becomes damaged during use, disconnect the supply cord from the mains immediately. **DO NOT TOUCH THE CORD BEFORE DISCONNECTING THE SUPPLY.**
11. Do not carry the appliance by the cable.
12. Disconnect the appliance from the mains supply.
 - whenever you leave the machine;
 - before clearing a blockage;
 - before checking, cleaning or working on the appliance;
 - if the appliance starts to vibrate abnormally.
13. Operate the appliance only in daylight or in good artificial light.
14. Do not overreach and keep your balance at all times.
15. Always be sure of your footing on slopes.
16. Walk, never run.
17. Keep all cooling air inlets clear of debris.
18. Never blow debris in the direction of bystanders.
19. **Never block suction inlet and/or blower outlet.**
 - **Do not block suction inlet or blower outlet to clean up in dusty areas.**
 - **Do not use the blower with a tapered nozzle smaller than the original one, such as a new nozzle obtained by attaching an extra diameter-reduced hose or smaller hose to the nozzle top end.**
 - **Do not Use the blower to inflate balls, rubber boat or the similar.**

Increased motor revolution may cause dangerous fan breakage and result in serious personal injury.
Heated motor and control circuit may cause a fire.

20. **It is recommended to use the long nozzle so the air stream can work close to the ground.**

Maintenance and storage

21. Keep all nuts, bolts and screws tight to be sure the appliance is in safe working condition.
22. Check the debris collector frequently for wear or deterioration.
23. Replace worn or damaged parts.
24. Use only genuine replacement parts and accessories
25. Store the appliance only in a dry place.

WARNING:

DO NOT let comfort or familiarity with product (gained from repeated use) replace strict adherence to safety rules for the subject product. MISUSE or failure to follow the safety rules stated in this instruction manual may cause serious personal injury.

SAVE THESE INSTRUCTIONS.

FUNCTIONAL DESCRIPTION

CAUTION:

- Always be sure that the tool is switched off and unplugged before adjusting or checking function on the tool.

Switch action

CAUTION:

- Before plugging in the tool, always check to see that the switch trigger actuates properly and returns to the "OFF" position when released.

For UB1102

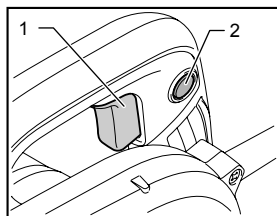

1. Switch trigger
2. Lock button

014263

To start the tool, simply pull the switch trigger. Release the switch trigger to stop.

For continuous operation, pull the switch trigger, push in the lock button and then release the switch trigger. Switch can be locked in "ON" position for ease of operator comfort during extended use. Apply caution when locking tool in "ON" position and maintain firm grasp on tool.

To stop the tool from the locked position, pull the switch trigger fully, then release it.

For UB1103

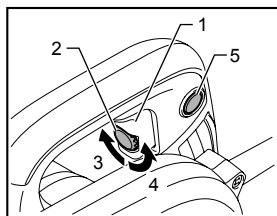

1. Switch trigger
2. Speed control screw
3. Higher
4. Lower
5. Lock button

014256

To start the tool, simply pull the switch trigger. Tool speed is increased by increasing pressure on the switch trigger. Release the switch trigger to stop. Switch can be locked in "ON" position for ease of operator comfort during extended use. Apply caution when locking tool in "ON" position and maintain firm grasp on tool.

For continuous operation, pull the switch trigger, push in the lock button and then release the switch trigger.

To stop the tool from the locked position, pull the switch trigger fully, then release it.

A speed control screw is provided so that maximum tool speed can be limited (variable). Turn the speed control screw clockwise for higher speed, and counterclockwise for lower speed.

OPERATION

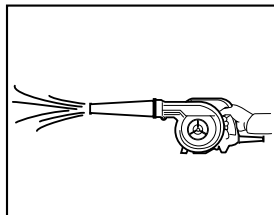

014419

CAUTION:

- Always hold the tool only by the handle when performing an operation. Do not touch the metal part.
- Do not use the tool for blowing air into objects, like rubber rafting, balls or other inflatable products. Increased motor revolution may cause dangerous fan breakage.

Blowing

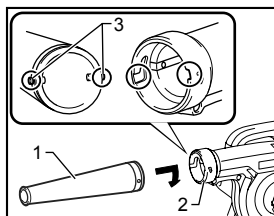

1. Nozzle
2. Blower outlet
3. Pin

014257

For dust blowing, attach nozzle to blower outlet. Turn it clockwise until it clicks.

Dust suction (optional accessory)

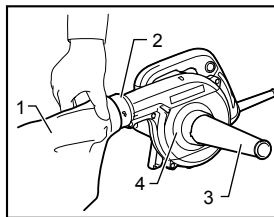

1. Dust bag
2. Blower outlet
3. Nozzle
4. Suction inlet

014258

For dust suction, fit nozzle onto suction inlet and dust bag onto blower outlet. Turn them clockwise until it clicks.

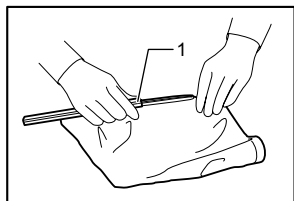

1. Fastener

004757

After the bag fills with dust, empty the contents of the dust bag into a dust bin by releasing the fastener.

MAINTENANCE

⚠CAUTION:

- Always be sure that the tool is switched off and unplugged before attempting to perform inspection or maintenance.
- Never use gasoline, benzine, thinner, alcohol or the like. Discoloration, deformation or cracks may result.

Replacing carbon brushes

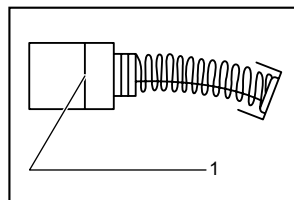

1. Limit mark

001145

Remove and check the carbon brushes regularly. Replace when they wear down to the limit mark. Keep the carbon brushes clean and free to slip in the holders. Both carbon brushes should be replaced at the same time. Use only identical carbon brushes.

Use a screwdriver to remove the brush holder caps. Take out the worn carbon brushes, insert the new ones and secure the brush holder caps.

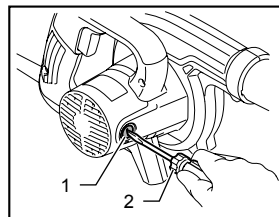

1. Brush holder cap
2. Screwdriver

014259

To maintain product SAFETY and RELIABILITY, repairs, any other maintenance or adjustment should be performed by Makita Authorized Service Centers, always using Makita replacement parts.

OPTIONAL ACCESSORIES

⚠CAUTION:

- These accessories or attachments are recommended for use with your Makita tool specified in this manual. The use of any other accessories or attachments might present a risk of injury to persons. Only use accessory or attachment for its stated purpose.

If you need any assistance for more details regarding these accessories, ask your local Makita Service Center.

- Joint
- Nozzle assembly
- Dust bag assembly
- Flexible hose
- Nozzle assembly (Long size)

NOTE:

- Some items in the list may be included in the tool package as standard accessories. They may differ from country to country.

[illegible]

[illegible]

Makita Corporation
Anjo, Aichi, Japan

885262A934

www.makita.com