

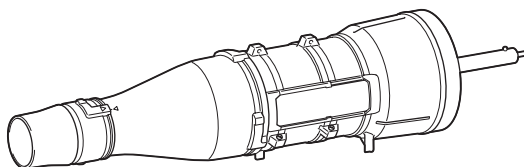

<b>EN</b>	Blower Attachment	ORIGINAL INSTRUCTION MANUAL	5
<b>PTBR</b>	Implemento Soprador	MANUAL DE INSTRUÇÕES ORIGINAL	12
<b>ES</b>	Accesorio de Soplado	MANUAL DE INSTRUCCIONES ORIGINAL	19
<b>ZHCN</b>	吹风附件	原版使用说明书	27
<b>ZHTW</b>	吹風機組	原始操作手冊	34
<b>KO</b>	브로어 어태치먼트	취급 설명서	41
<b>ID</b>	Perangkat Tambahan Blower	PETUNJUK PENGGUNAAN ASLI	47
<b>MS</b>	Alat Tambahan Penghembus	MANUAL ARAHAN ASAL	55
<b>VI</b>	Phụ Kiện Thổi	TÀI LIỆU HƯỚNG DẪN GỐC	63
<b>TH</b>	อุปกรณ์ต่อพ่วงเครื่องเป่าลม	ต้นฉบับคู่มือการใช้งาน	70
<b>AR</b>	ملحق نافخة الهواء	دليل الإرشادات الأصلي	84
<b>FA</b>	ضمیمه دمنده	دفترچه راهنمای اصلی	90

## UB401MP

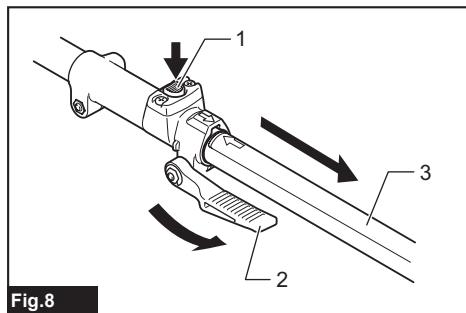

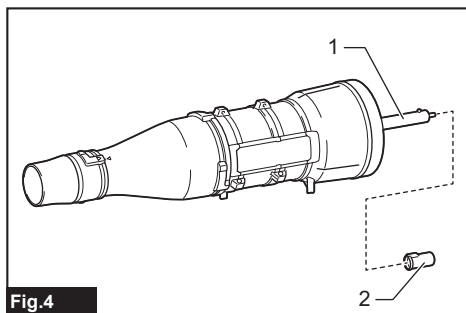
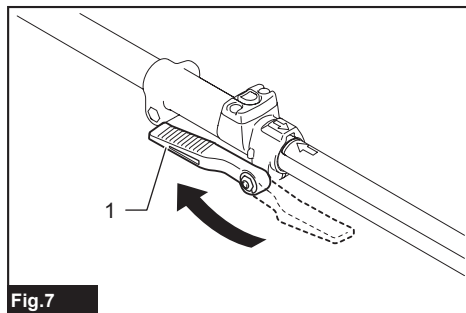
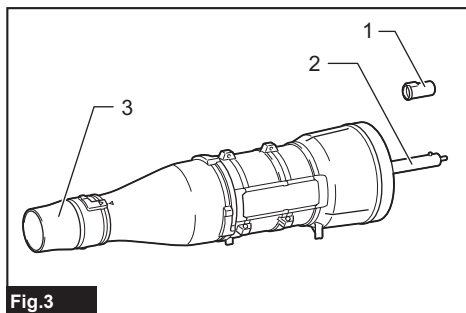
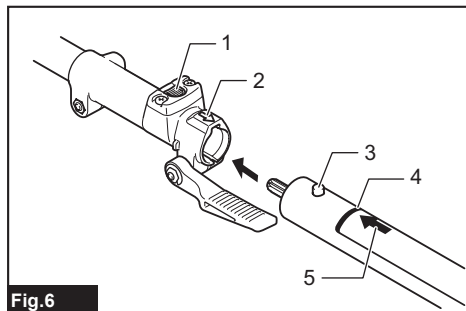
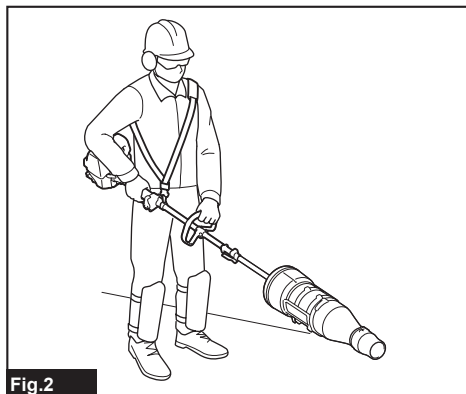
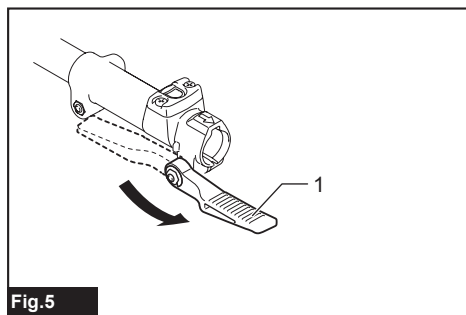
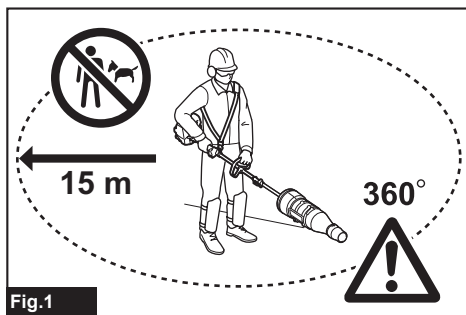

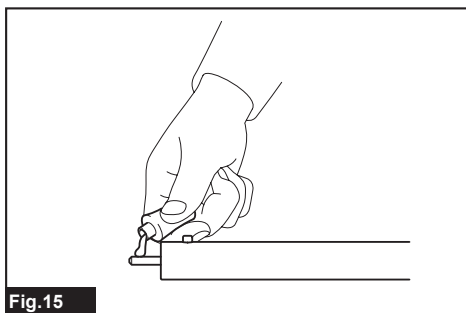
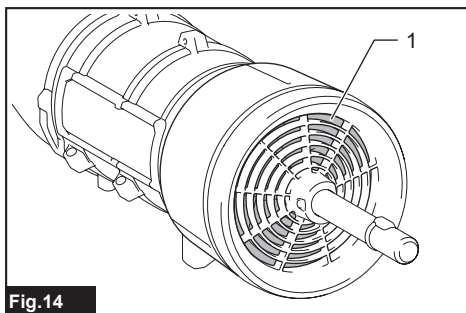
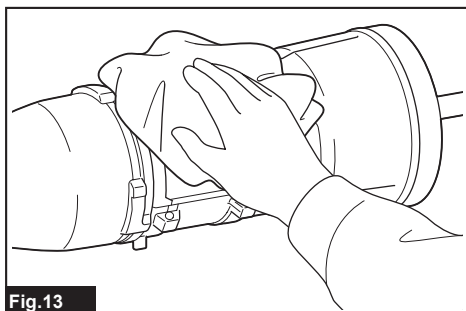
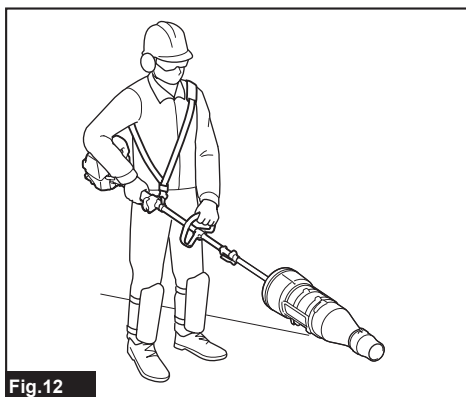
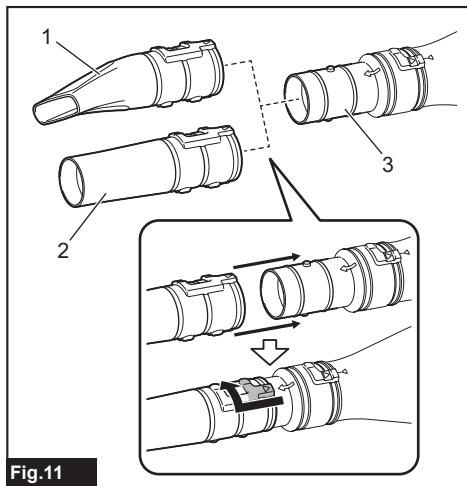
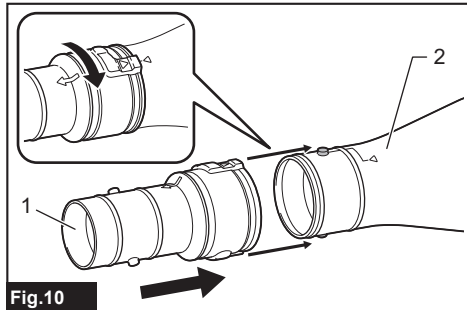
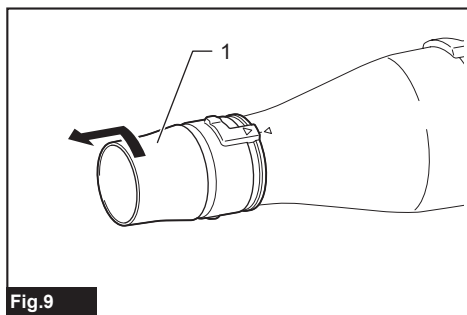

**Fig.16**

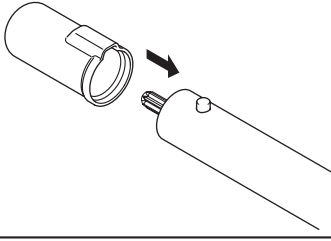

# SPECIFICATIONS

Model:		UB401MP
Capacities *1	Air volume	0 - 14.6 m <sup>3</sup> /min
	Air speed (average)	0 - 48.3 m/s
	Air speed (max.)	0 - 58.1 m/s
Capacities *2	Air volume	0 - 12.4 m <sup>3</sup> /min
	Air speed (average)	0 - 41.2 m/s
	Air speed (max.)	0 - 49.7 m/s
Capacities *3	Air volume	0 - 15.6 m <sup>3</sup> /min
	Air speed (average)	0 - 51.7 m/s
	Air speed (max.)	0 - 62.1 m/s
Capacities *4	Air volume	0 - 14.1 m <sup>3</sup> /min
	Air speed (average)	0 - 46.7 m/s
	Air speed (max.)	0 - 56.1 m/s
Overall length		895 mm
Net weight		2.1 kg

- \*1. Capacities of blower attachment in conjunction with DUX60 Cordless Multi Function Power Head
- \*2. Capacities of blower attachment in conjunction with DUX18 Cordless Multi Function Power Head
- \*3. Capacities of blower attachment in conjunction with UX01G Cordless Multi Function Power Head (with battery BL4040)
- \*4. Capacities of blower attachment in conjunction with EX2650LH Multi Function Power Head
- Due to our continuing program of research and development, the specifications herein are subject to change without notice.
- Specifications may differ from country to country.

## Approved power unit

This attachment is approved to use only with the following power unit(s):

- DUX60 Cordless multi function power head
- DUX18 Cordless multi function power head
- UX01G Cordless multi function power head
- EX2650LH Multi function power head

**⚠ WARNING: Never use the attachment with non-approved power unit. Non-approved combination may cause serious injury.**

**NOTE:** In European countries, UK, Russia, Australia, New Zealand, Korea, China, South Africa, etc. which have EMI regulation, this attachment cannot be used in conjunction with DUX60 manufactured before October 2020.

## Symbols

The followings show the symbols which may be used for the equipment. Be sure that you understand their meaning before use.



Take particular care and attention.



Read instruction manual.



Keep hands away from rotating parts.



Keep bystanders away.



Wear eye and ear protection.



Long hair may cause entanglement accident.



Keep distance at least 15 m.



Only for EU countries  
Do not dispose of electric equipment or battery pack together with household waste material!  
In observance of the European Directives, on Waste Electric and Electronic Equipment and Batteries and Accumulators and Waste Batteries and Accumulators and their implementation in accordance with national laws, electric equipment and batteries and battery pack(s) that have reached the end of their life must be collected separately and returned to an environmentally compatible recycling facility.

## Intended use

This attachment is designed for only the purpose of blowing dust in conjunction with an approved power unit. Never use the attachment for other purposes. Abusing the attachment may cause serious injury.

## SAFETY WARNINGS

### Blower Safety Instructions

**⚠ WARNING:** Read all safety warnings, instructions, illustrations and specifications provided with this machine as well as the instruction manual of the power unit before using. Failure to follow all instructions listed below may result in electric shock, fire, and/or serious injury to the operator and/or bystanders.

### Save all warnings and instructions for future reference.

The term "blower" and "machine" in the warnings and precautions refer to the combination of the attachment and the power unit.

The term "motor" in the warnings and precautions refers to the engine or electric motor of the power unit.

#### Training

1. Read the instructions carefully. Be familiar with the controls and the correct use of the blower.
2. Never allow children, persons with reduced physical, sensory or mental capabilities or lack of experience and knowledge or people unfamiliar with these instructions to use the blower. Local regulations may restrict the age of the operator.
3. Never operate the blower while people, especially children, or pets are nearby.
4. Keep in mind that the operator or user is responsible for accidents or hazards occurring to other people or their property.

#### Preparation

1. Always wear substantial footwear and long trousers while operating the blower.
2. Do not wear loose clothing or jewellery that can be drawn into the air inlet. Keep long hair away from the air inlets.
3. Always wear protective goggles to protect your eyes from injury when using power tools. The goggles must comply with ANSI Z87.1 in the USA, EN 166 in Europe, or AS/NZS 1336 in Australia/New Zealand. In Australia/New Zealand, it is legally required to wear a face shield to protect your face, too.

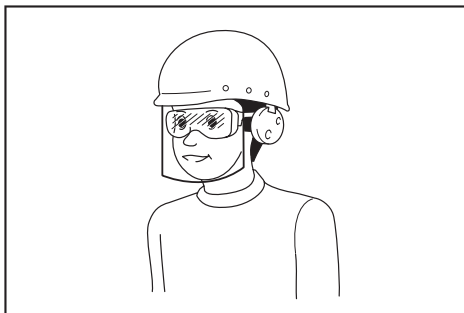

It is an employer's responsibility to enforce the use of appropriate safety protective equipments by the tool operators and by other persons in the immediate working area.

4. To prevent dust irritation the wearing of a face mask is recommended.
5. While operating the machine, always wear non-slip and protective footwear. Non-skid, closed-toed safety boots and shoes will reduce the risk of injury.
6. Wear ear protection, such as ear muffs. Exposure to noise can cause hearing loss.
7. Start and operate the engine only outdoors in a well ventilated area. Operation in a confined or poorly ventilated area can result in death due to suffocation or carbon monoxide poisoning.

#### Operation

1. Clear the area of children, bystanders, and pets. At a minimum, keep all children, bystanders, and pets outside a 15 m radius; outside the 15 m zone, there is still a risk of injury from thrown objects. Bystanders should be encouraged to wear eye protection. If you are approached, stop the engine or machine.

#### ► Fig.1

2. Switch off the blower and remove the battery cartridge or the spark plug cap, and make sure that all moving parts have come to a complete stop
  - whenever you leave the blower.
  - before clearing blockages.
  - before checking, cleaning or working on the blower.
  - if the blower starts to vibrate abnormally.
3. Operate the blower only in daylight or in good artificial light.
4. Do not overreach and keep proper balance and footing at all times.
5. Always be sure of your footing on slopes.
6. Walk, never run.
7. Keep all cooling air inlets clear of debris.
8. Never blow debris in the direction of bystanders.
9. Operate the blower in a recommended position and on a firm surface.
10. Do not operate the blower at high places.
11. Never point the nozzle at anyone in the vicinity when using the blower.

12. Never block suction inlet and/or blower outlet.
    - Be careful not to block suction inlet or blower outlet with dust or dirt when operating in dusty area.
    - Do not use nozzles other than the nozzles provided by Makita.
    - Do not use the blower to inflate balls, rubber boat or the similar.
  13. Do not operate the blower near open window, etc.
  14. Operating the blower only at reasonable hours is recommended - not early in the morning or late at night when people might be disturbed.
  15. Using rakes and brooms to loosen debris before blowing is recommended.
  16. Before blowing, slightly dampen surfaces in dusty conditions or use water mist sprayer if necessary.
  17. Adjust the length of the blower nozzle so that the air stream can work close to the ground.
  18. If the blower strikes any foreign objects or should start making any unusual noise or vibration, immediately switch off the blower to stop it. Remove the battery cartridge or the spark plug cap, and inspect the blower for damage before restarting and operating the blower. If the blower is damaged, ask Makita Authorized Service Centers for repair.
  19. Do not insert fingers or other objects into suction inlet or blower outlet.
  20. Prevent unintentional starting. Ensure the switch is in the off-position before inserting battery cartridge, picking up or carrying the blower. Carrying the blower with your finger on the switch or energizing the blower that has the switch on invites accidents.
  21. Never blow dangerous materials, such as nails, fragments of glass, or blades.
  22. Do not operate the blower near flammable materials.
  23. Avoid operating the blower for a long time in low temperature environment.
  24. Before assembling or adjusting the machine, switch off the motor and remove the spark plug cap or the battery cartridge.
  25. Wear the personal protective equipments before starting the motor.
  26. Before starting the motor, inspect the machine for damages, loose screws/nuts or improper assembly. Check all control levers and switches for easy action. Clean and dry the handles.
  27. Never attempt to start the motor if the machine is damaged or not fully assembled.
  28. Adjust the shoulder harness and hand grip to suit the operator's body size.
  29. With the engine running only at idle, attach the shoulder harness.
  30. During operation, use the shoulder harness. Keep the machine on your right side firmly.
  31. Hold the front handle with the left hand and the rear grip with the right hand, no matter you are right-hander or left-hander. Wrap your fingers and thumbs around the handles.
  32. Never attempt to operate the machine with one hand. Loss of control may result in an injury.
  33. If the machine gets heavy impact or fall, check the condition before continuing work. Check the fuel system for fuel leakage and the controls and safety devices for malfunction. If there is any damage or doubt, ask our authorized service center for the inspection and repair.
  34. Follow the instruction manual of the power unit for proper use of the control lever and switch.
  35. During or after operation, do not put the hot machine onto dry grass or combustible materials.
  36. Refer to the instruction manual of the power unit for how to start and control the machine.
- ### Refueling
1. Stop the engine before refueling. Keep away from open flames and sparks. Never smoke during refueling. Otherwise fire and/or explosion may result.
  2. Refuel outdoors. Refueling in a closed room can cause explosion of fuel vapor.
  3. Avoid contact with fuel or engine oil. Do not inhale fuel vapor. If fuel or oil spills, wipe it off of the machine and/or ground immediately. If fuel spills on your clothes, change it immediately to prevent it from catching fire.
  4. After refueling, carefully tighten the fuel tank cap and check for fuel leak. Move at least 3 m (10 feet) away from the fueling source and site before starting engine.
  5. Only transport and store fuel in approved containers. Keep children away from the stored fuel.
- ### Transportation
1. Stop the motor during transportation. Otherwise unintentional start-up may cause injury.
  2. Ensure safe position of the machine during car transportation to avoid fuel leakage.
  3. Lift the entire machine from the ground when carrying the machine. Dragging the machine causes fuel tank damage and fuel leakage, resulting in fire.
  4. When transporting the equipment, carry it in a horizontal position by holding the shaft. Keep the hot muffler away from your body.
- ### Vibration
1. Exposing to excessive vibration injures blood vessels or nervous system of the operator and causes the following symptoms in the fingers, hands or wrists: "Falling asleep" (numbness), tingling, pain, stabbing sensation, alteration of skin color or of the skin. If any of these symptoms occur, see a physician. To reduce the risk of "white finger disease", keep your hands warm during operation and well maintain the machine and accessories.

► Fig.2

## Maintenance and storage

1. Keep all nuts, bolts and screws tight to be sure the blower is in safe working condition.
2. If the parts are worn or damaged, replace them with parts provided by Makita.
3. Store the blower in a dry place out of the reach of children.
4. When you stop the blower for inspection, servicing, storage, or changing accessory, switch off the blower and make sure that all moving parts come to a complete stop, and remove the battery cartridge or the spark plug cap. Cool down the blower before making any work on the blower. Maintain the blower with care and keep it clean.
5. Always cool down the blower before storing.
6. Do not expose the blower to rain. Store the blower indoors.
7. When you lift the blower, be sure to bend your knees and be careful not to hurt your back.
8. To reduce the risk of fire, never service the equipment in the vicinity of fire.
9. Always clean dust and dirt off the equipment. Never use gasoline, benzine, thinner, alcohol or the like for the purpose. Discoloration, deformation or cracks of the plastic components may result.
10. After each use, tighten all screws and nuts, except for the carburetor adjustment screws.
11. Do not attempt any maintenance or repair not described in this instruction manual or the instruction manual of the power unit. Ask our authorized service center for such work.
12. Follow instructions for lubricating and changing accessories.
13. Always use the genuine spare parts and accessories only. Using parts or accessories supplied by a third party may result in the equipment breakdown, property damage and/or serious injury.
14. Request our authorized service center to inspect and maintain the machine at regular interval.
15. Before storing the machine, perform full cleaning and maintenance. Remove the spark plug cap or the battery cartridge. Drain the fuel after the engine gets cold.
16. Do not prop the equipment against something, such as a wall. Otherwise it may fall suddenly and cause an injury.

## Battery tool use and care

1. Recharge only with the charger specified by the manufacturer. A charger that is suitable for one type of battery pack may create a risk of fire when used with another battery pack.
2. Use power tools only with specifically designated battery packs. Use of any other battery packs may create a risk of injury and fire.
3. When battery pack is not in use, keep it away from other metal objects, like paper clips, coins, keys, nails, screws or other small metal objects, that can make a connection from one terminal to another. Shorting the battery terminals together may cause burns or a fire.

4. Under abusive conditions, liquid may be ejected from the battery; avoid contact. If contact accidentally occurs, flush with water. If liquid contacts eyes, additionally seek medical help. Liquid ejected from the battery may cause irritation or burns.
5. Do not use a battery pack or tool that is damaged or modified. Damaged or modified batteries may exhibit unpredictable behaviour resulting in fire, explosion or risk of injury.
6. Do not expose a battery pack or tool to fire or excessive temperature. Exposure to fire or temperature above 130 °C may cause explosion.
7. Follow all charging instructions and do not charge the battery pack or tool outside the temperature range specified in the instructions. Charging improperly or at temperatures outside the specified range may damage the battery and increase the risk of fire.

## Electrical and battery safety

1. Do not dispose of the battery(ies) in a fire. The cell may explode. Check with local codes for possible special disposal instructions.
2. Do not open or mutilate the battery(ies). Released electrolyte is corrosive and may cause damage to the eyes or skin. It may be toxic if swallowed.
3. Do not charge battery in rain, or in wet locations.
4. Do not charge the battery outdoors.
5. Do not handle charger, including charger plug, and charger terminals with wet hands.

## Service

1. Have your power tool serviced by a qualified repair person using only identical replacement parts. This will ensure that the safety of the power tool is maintained.
2. Never service damaged battery packs. Service of battery packs should only be performed by the manufacturer or authorized service providers.

## First Aid

1. In case of accident make sure that a first-aid box is available in the vicinity of the operations. Immediately replace any item taken from the first aid box.
2. When asking for help, give the following information:
  - Place of accident
  - What happened
  - Number of injured persons
  - Kind of injuries
  - Your name

## SAVE THESE INSTRUCTIONS.

**⚠WARNING:** DO NOT let comfort or familiarity with product (gained from repeated use) replace strict adherence to safety rules for the subject product.

MISUSE or failure to follow the safety rules stated in this instruction manual may cause serious personal injury.



**⚠ WARNING:** Use of this product can create dust containing chemicals which may cause respiratory or other illnesses. Some examples of these chemicals are compounds found in pesticides, insecticides, fertilizers and herbicides. Your risk from these exposures varies, depending on how often you do this type of work. To reduce your exposure to these chemicals: work in a well ventilated area, and work with approved safety equipment, such as those dust masks that are specially designed to filter out microscopic particles.

## PARTS DESCRIPTION

► Fig.3: 1. Cap 2. Pipe 3. Front nozzle

## ASSEMBLY

**⚠ WARNING:** Before assembling or adjusting the equipment, switch off the motor or engine and remove the spark plug cap or battery cartridge. Otherwise, the fans may move and result in an injury.

**⚠ WARNING:** When assembling or adjusting the equipment, always put it down. Assembling or adjusting the equipment in an upright position may result in serious injury.

**⚠ WARNING:** Follow the warnings and precautions in the chapter "SAFETY WARNINGS" and the instruction manual of the power unit.

### Mounting the attachment pipe

**⚠ CAUTION:** Always check that the attachment pipe is secured after installation. Improper installation may cause the attachment falling off from the power unit and cause personal injury.

Mount the attachment pipe to the power unit.

1. Remove the cap from the end of the pipe.

► Fig.4: 1. Pipe 2. Cap

**NOTICE:** Do not dispose of the cap since the cap is necessary for storing the attachment.

2. Turn the lever toward the attachment.

► Fig.5: 1. Lever

3. Align the pin with the arrow mark on the power unit. Insert the pipe until the release button pops up.

Make sure that the position line is on the tip of the arrow mark on the power unit, and the arrow mark on the power unit and the arrow mark on the pipe are facing each other.

► Fig.6: 1. Release button 2. Arrow mark on the power unit 3. Pin 4. Position line 5. Arrow mark on the pipe

4. Turn the lever toward the power unit.

► Fig.7: 1. Lever

Make sure that the surface of the lever is parallel to the pipe.

**NOTICE:** Do not tighten the lever without the attachment pipe inserted. Otherwise the lever may tighten the entrance of the drive shaft too much and damage it.

To remove the pipe, turn the lever toward the attachment and pull the pipe out while pressing down the release button.

► Fig.8: 1. Release button 2. Lever 3. Pipe

## Installing the flat nozzle or extension nozzle

### Optional accessory

1. Remove the front nozzle by turning it as shown in the figure.

► Fig.9: 1. Front nozzle

2. Attach the adapter pipe to the attachment, and then turn it to lock it into place.

► Fig.10: 1. Adapter pipe 2. Attachment

3. Attach the flat nozzle or extension nozzle to the adapter pipe, and then turn it to lock it into place.

► Fig.11: 1. Flat nozzle 2. Extension nozzle  
3. Adapter pipe

**NOTICE:** The grooves on the deep side of the flat nozzle or extension nozzle are not available. Be sure to use the grooves shown in the figure to attach the flat nozzle or extension nozzle.

## OPERATION

**⚠ WARNING:** Follow the warnings and precautions in the chapter "SAFETY WARNINGS" and the instruction manual of the power unit.

**⚠ WARNING:** Adjust the hanger position and shoulder harness to your comfortable position before operating.

**⚠ CAUTION:** Do not place the machine on the ground while it is switched on. Sand or dust may enter from suction inlet and cause a malfunction or personal injury.

Hold the machine firmly with both hands and perform the blowing operation by moving it around slowly. When blowing around building, big stone or vehicle, direct the nozzle away from them. When performing an operation in a corner, start from the corner and then move to wide area.

Adjust the air speed with the switch trigger or throttle lever of the power unit according to the environment or conditions of your usage.

► Fig.12

## MAINTENANCE

**⚠ WARNING:** Before inspecting or maintaining the equipment, switch off the motor and remove the battery cartridge, or stop the engine and remove the spark plug cap. Otherwise, the fans may move and result in serious injury.

**⚠ WARNING:** When inspecting or maintaining the equipment, always put it down. Assembling or adjusting the equipment in an upright position may result in serious injury.

**⚠ WARNING:** Follow the warnings and precautions in the chapter “SAFETY WARNINGS” and the instruction manual of the power unit.

**NOTICE:** Never use gasoline, benzine, thinner, alcohol or the like. Discoloration, deformation or cracks may result.

To maintain product SAFETY and RELIABILITY, repairs, any other maintenance or adjustment should be performed by Makita Authorized or Factory Service Centers, always using Makita replacement parts.

### Cleaning the machine

Clean the machine by wiping off dust with a dry cloth or one dipped in soapy water and wrung out.

► Fig.13

Remove dust or dirt from the suction inlet at the rear of the attachment.

► Fig.14: 1. Suction inlet

## Interval of inspection and maintenance

Operating hour		Before Operation	Daily (10 hours)	30 hours
Whole unit	Visually inspect for damaged parts	✓	-	-
Drive axle	Supply grease	-	-	✓
Power unit	Refer to the instruction manual of the power unit			

## Overall inspection

Check for damaged parts. Ask our authorized service center to replace them if necessary.

## Lubricating moving parts

**NOTICE:** Follow the instruction of the frequency and amount of grease supplied. Otherwise insufficient lubrication may damage moving parts.

### Drive axle:

Apply grease (Makita grease N No.2 or equivalent) every 30 hours of operation.

► Fig.15

**NOTE:** Genuine Makita grease may be purchased from your local Makita dealer.

## Storage

When storing the attachment separated from the power unit, put the cap onto the end of the pipe.

► Fig.16

# TROUBLESHOOTING

Before asking for repairs, conduct your own inspection first. If you find a problem that is not explained in the manual, do not attempt to disassemble the machine. Instead, ask Makita Authorized Service Centers, always using Makita replacement parts for repairs.

State of abnormality	Probable cause (malfunction)	Remedy
Motor or engine does not start.	-	Refer to the instruction manual of the power unit.
Motor or engine stops soon.	-	Refer to the instruction manual of the power unit.
Motor or engine speed does not increase.	-	Refer to the instruction manual of the power unit.
Fans do not rotate. ⇒ Stop the motor or engine immediately.	The pipes of the power unit and the attachment are not connected properly.	Connect the pipes in the correct way.
	Abnormal drive system	Contact an authorized service center for repairs.
Power unit vibrates abnormally. ⇒ Stop the motor or engine immediately.	Abnormal drive system	Contact an authorized service center for repairs.
Fans continue to rotate even if the switch trigger/lever is released. ⇒ Stop the motor or engine immediately.	The power unit does not work properly.	Adjust the idle speed if the power unit is engine-operated. Contact an authorized service center for repairs.

## OPTIONAL ACCESSORIES

**⚠ CAUTION:** These accessories or attachments are recommended for use with your Makita machine specified in this manual. The use of any other accessories or attachments might present a risk of injury to persons. Only use accessory or attachment for its stated purpose.

If you need any assistance for more details regarding these accessories, ask your local Makita Service Center.

- Adapter pipe
- Extension nozzle
- Flat nozzle
- Gutter nozzle set
- Makita genuine battery and charger

**NOTE:** Some items in the list may be included in the product package as standard accessories. They may differ from country to country.



**Makita Corporation**  
3-11-8, Sumiyoshi-cho,  
Anjo, Aichi 446-8502 Japan  
[www.makita.com](http://www.makita.com)

885865-910  
EN, PTBR, ES,  
ZHCN, ZHTW, KO,  
ID, MS, VI, TH, AR,  
FA  
20201120