

Makita

40V Max Brushless AWS Dust Extraction Vacuum

XGT

HEAVY DUTY BRUSHLESS

HEPA
filter

Makita

XGT

VC004G



Product Statement



The VC004G provides a massive max sealed suction of 23kPa, equivalent to 240V vacuums.

The hoses and cuffs can be fitted to a wide range of tools for dust extraction and the standard pipes and floor tool can be used for vacuuming hard or carpeted floors.

Auto-start Wireless System (AWS) provides ultimate efficiency when using VC004G as a dust extractor, by automatically starting the vacuum when the tool is turned on.

VC004G features dual battery indicators so you're never left short of power and the soft bumper around the base prevents any damage if the vac encounters a wall or furniture. Operating in parallel, the dual XGT batteries provide long runtime of 28 minutes at Max suction on 2 x BL4050F batteries, or a whopping 3.5 hours on low.



Product Overview



HEAVY DUTY BRUSHLESS



Product Specification Sheet



Max suction	23kPa
Max air volume	1.7m ³ /min
Tank capacity	15L
Continuous runtime BL4050F x2	28 minutes
Suction power	200W
Overall length	475mm
Skin weight	7.9kg
Voltage	40V Max

- **Massive Suction Power** – 23kPa equivalent to AC 240V dust extraction vacuums.
- **AWS** – Automatically starts the vacuum when connected to a tool with Bluetooth connectivity
- **HEPA Filter** – High Efficiency Particulate Air filter for high filtration rate of up to 99.97%
- **Durable Container** – Durable plastic container absorbs impacts without denting or warping like metal containers
- **Dual Battery Indicator** – Indicates the remaining power in each battery
- **Variable Speed Dial** – easily adjustable suction control for optimum runtime and efficiency
- **Dust Extraction Cuffs** – standard accessory cuffs connect to a large range of Makita tools and extraction attachments
- **15L Tank Capacity** – large tank capacity to minimise down time between disposals

Advantages



HEAVY DUTY BRUSHLESS

Performance



40V Max Brushless motor provides massive 23kPa Max sealed suction

Innovation



Auto-start Wireless System for on demand dust extraction

Convenience



Functional control panel for AWS setup, suction control & battery capacity

Efficiency



3 stage HEPA filtration for 99.97% filtration at 0.3 microns

Advantages





Our range of AWS Dust Extraction Vacuums can pair to a range of LXT & XGT tools thanks to the Auto-Start Wireless System.

This feature enables automatic start up of the vacuum when the trigger is pulled on the tool for on demand dust extraction.

They will also run for several seconds after the trigger has been released to pull any remaining material completely through the hose.

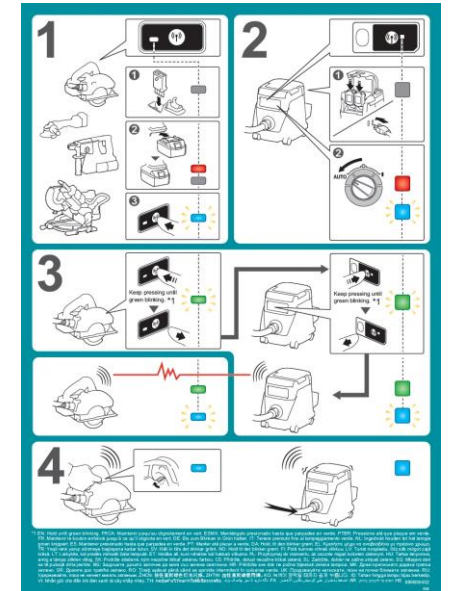

How to pair your tools

1. Ensure the Dust Extractor & Tool have an AWS chips inserted.
2. Turn the Dust Extractor power dial to "AUTO."
3. Press and hold the  button on the Dust Extractor for 3 seconds until the light flashes **Green**.
4. Press and hold the  button on the tool for 3 seconds until the light flashes **Green**.
5. Lights will turn to flashing **Blue** when the two units are paired.



[Click Here for instructional video – Pairing Bluetooth Tools](#)

Standard Accessories		
	195433-3	28mm Hose x 3.5m
	195434-1	38mm Hose x 2.5m
	195547-8	Front Cuff 22
	195546-0	Joint Cuff 22-38
	195551-7	Universal Floor Nozzle
	192562-3	Aluminium Bent Pipe
	192563-1	Aluminum Straight Pipe

Standard Accessories		
	410306-2	Crevice Nozzle
	198901-5	AWS Bluetooth Chip
	195432-5	Plastic Tub Liner (10pk)

Optional Accessories / Spares		
	195557-5	Fleece Filter Bag (5pk)

Dust Extraction



	Part Number	Description	Suitable For
	195433-3	28mm Hose x 3.5m	<p>Front Cuff 38 fitted standard on 28mm hose.</p> <p>Example Products – Slide Compound Saws, Routers, Trimmers, Angle Grinder Attachments, Wall Chaser.</p>
	195434-1	38mm Hose x 2.5m	<p>Standard cuff is 38mm.</p> <p>Example Products – Slide Compound Saws, Routers, Trimmers, Angle Grinder Attachments, Wall Chaser.</p>
	195547-8	Front Cuff 22	<p>Replaces Front Cuff 38 on 28mm hose.</p> <p>Suits – Multitools, Rotary Hammer Attachments, Sanders.</p>
	195546-0	Joint Cuff 22-38	<p>Fits onto Front Cuff 22 or Inside Front Cuff 38</p> <p>Suits – Circular Saws, Plunge Cut Saws, Sanders, Jigsaws.</p>