

Makita

18V Brushless AWS 18mm SDS Plus Rotary Hammer

DHR182



BRUSHLESS

WIRELESS, ON DEMAND, DUST EXTRACTION

Makita's Auto-start Wireless System (AWS) has modernised on-demand dust extraction to meet the needs of cordless power tool users. AWS allows you to work with maximum efficiency, without the hazard of dust & leads. Featuring our legendary cordless technology, the AWS range has the power, speed & runtime to keep you ahead of the game.



Makita

LXT

THE LXT ADVANTAGE

4 key components make up our LXT® Advantage, providing you with the most advanced, dependable 18V tools on the market. Our fast-charging batteries, rapid optimum chargers, industry leading brushless motors and our STAR Protection computer controls make each and every one of the world's largest 18V range of tools the best option for the job, no question.



Product Objectives

- Designed to suit any user with high performance demands such as industrial fit outs, construction and demolition.
- Develop a compact and lightweight brushless rotary hammer, featuring AVT to significantly reduce vibration and AWS for on demand dust extraction



Product Overview

AVT
ANTI VIBRATION TECHNOLOGY

3 mode operation

Torque limiting clutch

Optional onboard dust extraction

Brushless Motor

Variable speed trigger

LED Joblight

AWS
Auto - start Wireless System

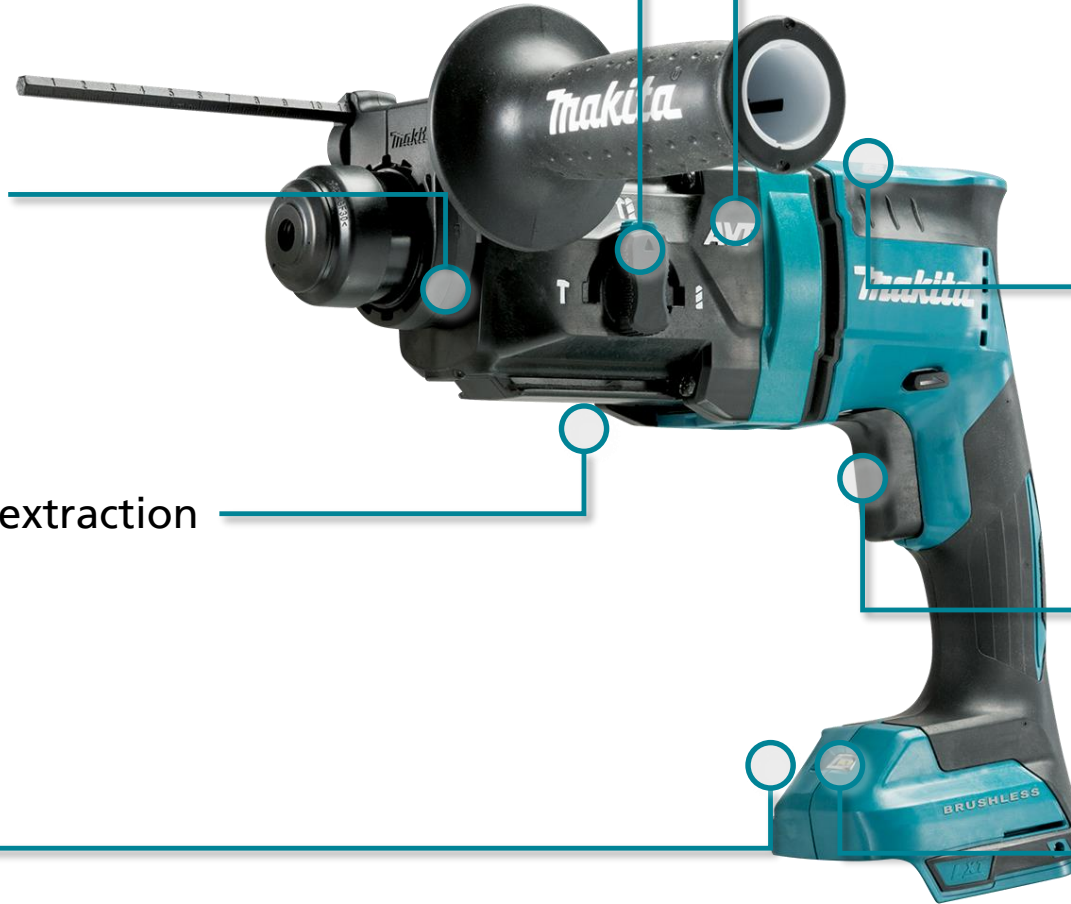

*AWS receiver sold separately

Product Specification Sheet



Max. drilling capacities in wood	24mm
Max. drilling capacities in steel	13mm
Max. drilling capacities in masonry	18mm
Impact energy	1.7J
No load speed	0-1,350rpm
Impact rate	0-5,000ipm
Vibration	11.0m/s ²
Overall length	301mm
Skin weight	2.6kg
Weight (with battery)	3.2kg
Voltage	18V

- **3 mode operation** – select between Rotation only, Hammer only & Rotation with Hammer
- **Torque limiting clutch** – torque limiting clutch is engineered to prevent gear damage by automatically disengaging gears if the bit binds
- **Optional onboard dust extraction** – can be fitted as an accessory for dust extraction without a separate vacuum
- **AWS*** – Auto-Start Wireless System, allows the tool and compatible vacuum to run automatically while the switch trigger is being pulled
- **AVT** – Anti-Vibration technology delivers unbelievably smooth performance at just 11.0m/s² thanks to the counter weight mechanism
- **Brushless Motor** – efficient energy production more power, lower heat production and increased work on a single charge
- **Variable speed trigger** – allows the user to adjust the speed based on application
- **LED Joblight** – bright LED light illuminates the work area for better visibility when working in poorly lit areas

* AWS receiver sold separately

Advantages

Innovation



AWS* delivers on demand dust extraction

Ergonomics

AVT

ANTI VIBRATION TECHNOLOGY

AVT Technology for working longer & safer

Dust Management



Optional onboard dust extraction unit available (199658-1)

Power



18V Brushless motor enables the motor to run cooler and more efficiently

* AWS receiver sold separately



Advantages

The DHR182 can pair to our 18Vx2 Brushless AWS Dust Extraction Vacuum (DVC864L) thanks to the new Auto-Start Wireless System.

This feature enables automatic start up of the vacuum when the trigger is pulled on the tool for on demand dust extraction.

The DVC864L will also run for several seconds after the trigger has been released to pull any remaining material completely through the hose.

How to pair your tools

1. Turn the DVC864L power dial to "AUTO."
2. Press and hold the  button on the DHR182 for 3 seconds until the light flashes Green.
3. Press and hold the  button on the DVC864L for 3 seconds until the light flashes Green.
4. Lights will turn to flashing Blue when the two units are paired.

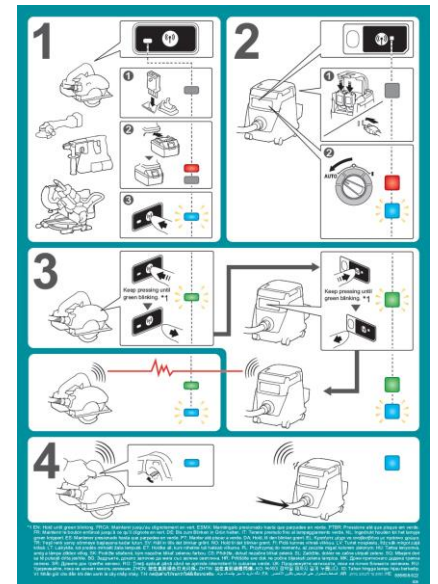

[Click Here for instructional video – Pairing Bluetooth Tools](#)

Our Range

	DHR165	DHR171	DHR182	DHR202	DHR242 / DHR243	DHR263 / DHR264	DHR282 / DHR283	DHR400
								
Max. capacities in masonry	16mm	17mm	18mm	20mm	24mm	26mm	28mm	40mm
Max. capacities in wood	24mm	13mm	24mm	26mm	27mm	32mm	32mm	-
Max. capacities in steel	13mm	10mm	13mm	13mm	13mm	13mm	13mm	-
Impact energy	1.3j	1.2j	1.7J	1.9j	2.0j	2.5j	2.8 / 2.9j	8.0j
No load speed	0 - 1,600rpm	0-680rpm	0-1,350rpm	0 - 1,100rpm	0 - 950rpm	0 - 1,250rpm	0 – 980rpm	250 – 500rpm
Impact rate	0 - 5,300ipm	0-4,800ipm	0-5,000ipm	0 - 4,000ipm	0 - 4,700ipm	0 - 5,000ipm	0 - 5,000ipm	1,450-2,900ipm
Vibration	12.0m/s ²	9.0m/s ²	11.0m/s ²	14.5m/s ²	13.5m/s ²	15.5m/s ²	9.0m/s ² / 9.5m/s ²	5.0m/s ²
Overall length	297mm	273mm	301mm	358mm	328mm	374mm	373mm / 404mm	473mm
Skin weight	1.9kg	2.2kg	2.6kg	2.6kg	2.7kg	4.1kg	3.7kg / 3.8kg	6.7kg
Weight (with battery)	2.5kg	2.8kg	3.2kg	3.2kg	3.3kg	4.7kg	5.0kg / 5.1kg	7.9kg
Voltage	18V	18V	18V	18V	18V	18Vx2	18Vx2	18Vx2

Accessories



Standard Accessories

	415486-9	Depth gauge
---	----------	-------------

Optional accessories

	199658-1	DX05 Dust Extraction Set
	199593-3	Tool Catcher Set
	198901-5	Wireless Unit
	194683-7	Bit grease

Optional accessories

	SDS Plus Bits	Refer to pages 152 to 165 Acc Cat 2015 / 16
	Demolition Bits	Refer to pages 182 to 183 Acc Cat 2015 / 16